

pH - ORP IMMERSION PROBE 9336

- Electrode holder and protection
- Easy calibration: buffer flask grips on
- Flange or PE collar fitting
- For any KCl gel type electrodes
- For PG 13.5 electrode threaded connection
- PVC, PPH or stainless steel construction
- Wire outlet through a PG 9

APPLICATIONS

This immersion probe 9336 is convenient for all pH or ORP measurements in tank, drain, basin, open channel.

Standard construction is of with grey PVC parts and a red PVC tube. The electrode holder in PVC or PPH is specially designed to avoid electrode damage during calibration. Electrode protection end is removed from the holder; the buffer flask (buffers 9011/ 9012/ 9013/ 9015) is then gripped on the holder during the entire calibration step. There is no need to hold the probe during these operations, it can stand on floor.

CODE NUMBERS AND REFERENCES

Code	Reference	Designation
130 150	9336 PVC	PVC 1 m long probe for one electrode
130 250	9336 PPH	PPH 1 m long probe for one electrode
131 150	9336 SS 316L	Stainless steel 1 m long probe for one electrode
130 112	9358 PE	ND50 PE flange, dip length adjustment for 9336
130 113	9337/ PPh	PPh bucket + PVC probe 9336

TECHNICAL FEATURES

Immersion height:	Standard length 1000 mm (from 200 to 3000 mm on request)
Construction:	PVC, PPH, or Stainless steel 316 L
Housing:	PBT glass fiber reinforced – IP 65
Cable output:	PG 9
Mounting:	With PE DN50 flange 9358; for dip adjustment or PE collar, 50 mm diameter
Maximal pressure:	4 bar / PVC and PPH 16 bar / Stainless steel
Maximal temperature:	55 °C / PVC 100 °C / PPH 135 °C / Stainless steel 316 L

Maximal pressure and temperature depend of mounted electrode.
Pressure and temperature value are not for simultaneous conditions.

ELECTRODES

Associated electrodes for our pH and ORP products are described on the documentation N° 150-01.

Only electrodes with sealing by Pg 13.5 thread could be mounted on our probes.

BAMO MESURES

22, Rue de la Voie des Bans - Z.I. de la Gare - 95100 ARGENTEUIL

Tél : (+33) 01 30 25 83 20 - Web : www.bamo.fr

Fax : (+33) 01 34 10 16 05 - E-mail : info@bamo.fr

pH - ORP
IMMERSION PROBE
9336

01-12-2009

130 I1 01 E

pH

130-01/1

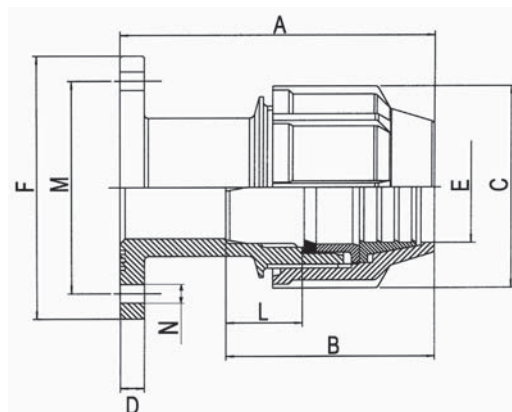
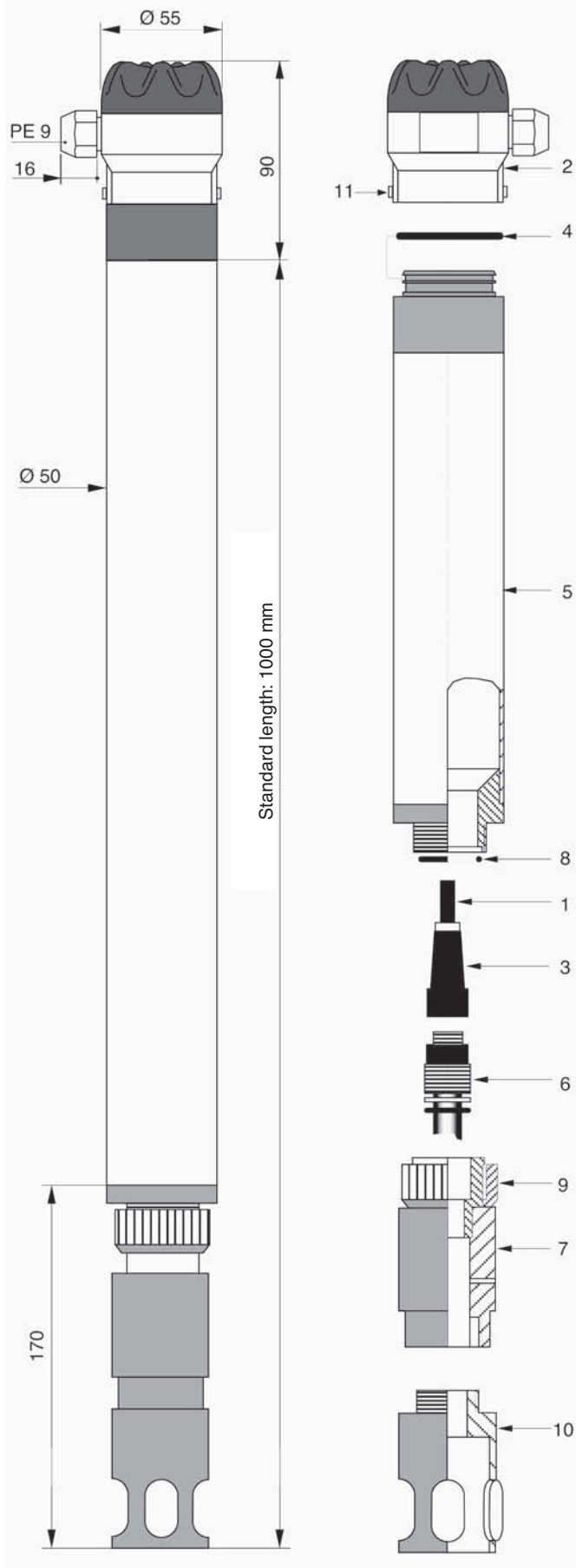

Type	DN	F	M	D	N (x4)	E	C	A
9358	50	163	125	10	Ø 18	52	95	143

ELECTRODE MOUNTING

Introduce the pH measurement cable 9060 (1) through the cable gland and probe head (2). A cable length of probe length plus 20 cm would be necessary.

Mount, connect and weld on the connector 9054 (3) to the cable (see documentation pH160 – msa160-9054).

Check the O' ring (4) is on place.

Screw the probe head (2) on extension tube (5).

Ensure that the connector goes out from the tube.

Install the pH or ORP electrode (6) on the holder (7).

Check the O' ring (8) is on place.

Screw tightly the connector on the electrode.

Pull smoothly the cable from through the cable gland, in order to have the electrode holder (7) close to the extension tube.

The cable must not be stretched inside the tube.

Screw the nut (9) keeping the holder (to protect the cable) in its position.

Tight firmly this nut by hand, not excessively.

Prevent the electrode holder to rotate during this operation.

Screw tightly the cable gland on the head.

Rotate the head in the good position and block it with the two screws (11)

ELECTRODE DISMOUNTING

To dismantle the electrode, proceed as above on reverse steps. Careful not to loose the O' ring.

CALIBRATION

You may find detailed all instructions in the instruction manuals of pH or ORP meters.

Unscrew the electrode protection end (10). Clean up the electrode with water (do not wrap it with paper neither tissue). Adapt the buffer flask on the holder (7).

The flask grips on it, the probe can lay down the floor.

Ending the calibration sequences, screw in the electrode protection and lock it smoothly.

BAMO MESURES

22, Rue de la Voie des Bans - Z.I. de la Gare - 95100 ARGENTEUIL

Tél : (+33) 01 30 25 83 20 - Web : www.bamo.fr

Fax : (+33) 01 34 10 16 05 - E-mail : info@bamo.fr

pH - ORP
IMMERSION PROBE
9336

01-12-2009

130 I1 01 E

pH

130-01/2